



FEATURES & BENEFITS



Finish

Surface finish after application is excellent and uniform due to best particle size distribution resulting in maximizing the strength and durability of the plaster.



Storage

Easy to maintain stock as the product is supplied in bags with uniform weight.



Easy Application

The plaster is single component pre-mixed under factory-controlled conditions. Only specified quantity of good quality water has to be added at site. This makes the process of plastering much easier and faster.



High Strength

High compressive strength increases masonry strength and load-bearing capacity of the substrate.



Shrinkage Cracks

Shrinkage cracks are taken care as high quality fibers are added to the ready-mix plaster. Raw materials which are tested and accurately measured are mixed with properly graded and proportioned fine aggregates.



Availability

Unlike the uncertain availability of good quality river sand, HITECH Ready Mix Plasters are available round the year.



Consistency

Due to the manufacturing process and accurate particle size distribution, all bags of the HITECH ready mix plasters are of consistently good quality.



Factory Controlled Ready Mix Plaster

No need for measuring, mixing or blending of cement & sand at site. Only predetermined specified quantity of good quality water is to be added at site.

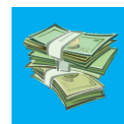

Economical and Time Saving

HITECH Ready Mix Plasters provide smooth finish wall surface even in a single coat. Eliminates the process of sourcing different raw materials at site for preparing plaster mix. Hence increases productivity, saves labour time and cost.



Higher Coverage

HITECH Ready Mix Plasters give a practical coverage of around 18.00 Sq.ft to 21.50 Sq. ft for an average thickness of 10mm to 12mm thickness.



Minimum Wastage

The wastage of materials caused in the conventional site mix plaster due to sand sieving & mixing as well as due to rebound losses are totally taken care. Hence negligible.



Hassle Free

No hassle of supervising and maintaining of Cement: Sand Ratio with HITECH Ready Mix Plasters. As against this, stringent supervision and labour are required to monitor the preparation of conventional site mix plaster.



SPECIFICATIONS

Appearance	Free Flowing Grey Powder
Binder	Ordinary Portland Cement OPC 53, Classified & Processed Fly Ash
Polypropylene Fibres	High Quality PP Fibres from leading reputed manufacturers
Additives	Performance enhancing proprietary additives to improve the properties of Plaster like spreadability and workability, anti-sagging, Shrinkage Compensation, adhesion strength, water resistant, durability and reduction of rebound wastage.
Fine Aggregates	100% River Sand which is Processed (i.e. Removal of impurities, Grading and Proportioning of River Sand) and with built in Specific Particle Size Distribution
Maximum Size of Fine Aggregate	3.00 mm
Water Demand	5 liters to 7 liters of Good Quality Water for one bag of 40kg. i.e. Approximately 12.50% to 17.50% for one bag of 40kg
Wet Density	Around 2000 kg per cubic meter
Initial Setting Time	150 minutes to 170 minutes
Final Setting Time	270 minutes to 300 minutes
Pot Life	60 minutes to 75 minutes
Compressive Strength	> 14.00 N/mm ² - After 28 days curing
Recommended Thickness	6 mm to 14 mm for 1st coat, 15mm to 25 mm for 2nd coat, 26 mm to 35 mm for 3rd coat. But Thickness shall not exceed 12 mm to 14 mm per day per layer of plaster coat.
Practical Coverage For one 40kg bag	For an average thickness of 10 mm 20.00 Sq. ft to 21.50 Sq. ft For an average thickness of 12 mm 17.50 Sq. ft to 18.00 Sq. ft This may vary from one site condition to another and from one applicator to another
Shelf Life	3 Months from the date of manufacturing, if stored in the originally sealed packaging and in recommended storage condition.
Storage	In dry place free from moisture & water like how OPC cement bags are stored
Packing	40 kg per bag

PREPARATION & APPLICATION

Concrete Block Joints

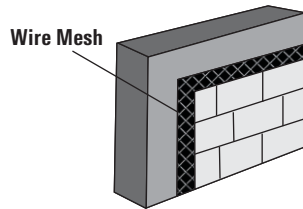

All concrete and Block / Brick joints must be covered with suitable chicken wire mesh

Surface Clean



The substrate should be cleaned well and free from oil, grease, paint, loose or dirt particles.

Wall Wetting

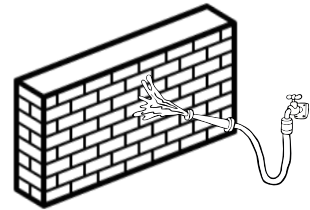

Before application of plaster, dampen the wall by spraying water and it should be in touch dry condition

Mix Preparation



Take minimum quantity of good quality water (within 5-7 litres) and add one bag of 40kg HITECH Ready Mix Plaster and slowly start mixing it for 7-8 minutes.

Mixing

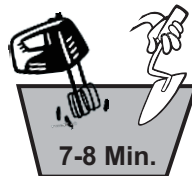

Mixing should be done for 7-8 minutes by taking minimum quantity of water to achieve desired consistency and workability

Leave to React

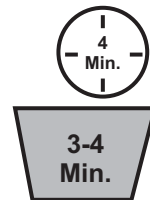

Leave the mix to react for 3-4 minutes. Remix for couple of minutes by adding little extra quantity of water, if necessary.

Cement Slurry/Bond Coat

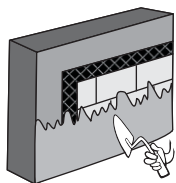

Apply cement slurry as base coat. If the surface is smooth and dense, the surface should be made rough by a suitable grinder/tools. Alternatively, suitable bond coat available from market can be applied.

Apply on Wall

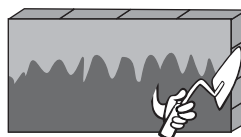

The mixture should be applied while the cement slurry (base coat) is wet. Ensure application with the help of suitable tools for a maximum thickness of 12mm to 14mm per coat per day.

Second Coat

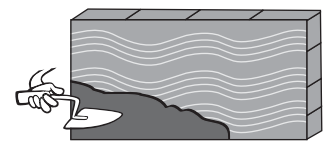

For 2nd and/or subsequent coats, ensure proper keying/grooving on the first coat and all other previous coats is done properly to provide good grip for the 2nd and all other subsequent coats.

Levelling

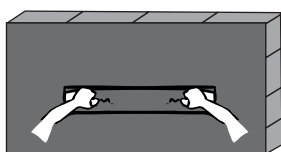

After final coat ensure proper levelling with the help of appropriate tools.

Water Curing

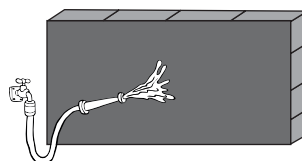

After 18 to 24 hours of Natural Air Curing, water curing should be done by spraying water, 5 to 6 times a day, for minimum 6 days.

Health Safety Precaution:
This product is non-toxic and non-hazardous. Use of gloves, dust-mask and goggles is recommended. In case of contact with eyes, wash eyes with plenty of clean water and immediate medical aid should be sought.

WARRANTY

The Products supplied by the Company **M/S. Hightec Chemplast Private Limited** are warranted to comply with the Product Specifications mentioned in this **Product Brochure and Product Literature**, provided they are applied and used in conformance with the processes and procedures described in this **Product Brochure and Product Literature** and as per the Standard Civil Engineering Practices.

In the unlikely event that the Products are found to be not in compliance with the mentioned specifications, the Company undertakes to replace the Products that are specifically determined to be non-compliant. Any suspected defects or non-compliance of the Products must be reported to the Company in writing within 72 hours of being detected or within 45 days of the supply of the Products, whichever is earlier. The Company shall have the right to inspect the area where the suspected defects are detected and in case any such suspected defect is determined to be caused specifically due to a deficiency in the Products supplied by the Company, the Company undertakes to provide replacement only for the specific area where the Product defect is observed and detected and not for the whole room, floor, building, or project where the Company's Products may have been used.

Since the Company does not have control over the installation or application or end use of the Products, the Warranty shall not cover any defects that may be caused due to defective or faulty or unskilled workmanship, application, curing or treatment of the Company's Products. The Warranty is limited only to replacement of the Products in question and does not cover any incidental and consequential costs or damages including, but not limited to, the costs of removal and reapplication of the Products, delays, loss of profits or any other liabilities that the purchaser/end user may incur towards themselves or any third parties.

The above Warranty is the complete set of Warranties offered by the Company on its Products and over rides any other Warranties that may be implied or expressed in any other Product Literature or that may erroneously be inferred by the purchaser through interactions with the Company's representatives or with any consultants, architects, etc.

The Company may, in the interests of customer service, relax the above Terms of Warranty. Any such relaxation shall be at the sole discretion of the Company and shall not be taken to be a precedent for the future. Such relaxation can only be authorized in writing by the CEO or the Directors of the Company. No other Company's representative shall have any rights to relax the Terms of the Warranty without explicit authorization in writing from the CEO or Directors.

DISCLAIMER

All recommendations, suggestions, statements and technical data provided in this **Product Brochure and Product Literature** are based on the best current knowledge available and are given for illustrative and informative purposes only and the Company does not bear any responsibility for any loss or damages that may be caused by the use / misuse of such data.

It is assumed that all Standard Civil Engineering Practices shall be adopted for the use and application of the Company's Products and all information provided in this **Product Brochure and Product Literature** are based on the above assumption. The Company shall not be responsible for any loss or damages that may be caused by a deviation from the Standard Civil Engineering Practices or by any use or application of the Company's products not in consonance with the information provided in this **Product Brochure and Product Literature**.

The Company supplies products as per the Specifications provided in this **Product Brochure and Product Literature** and all information in this **Product Brochure and Product Literature** are for general guidance of the purchasers/end users only. It is not possible, in this **Product Brochure and Product Literature**, to provide information with respect to all potential uses and applications of the Company's Products and for the various site conditions where the Products may be used.

Therefore, the Company makes no claims herein as to the particular suitability or fitness of the Products for specific applications or purposes. The Company may be contacted directly, if any additional information is required for any specific use or application of its Products, prior to the purchase and use of the Company's Products by the purchaser/end user.

The Company is continuously striving to improve and develop its products to better meet the industry requirements and to provide superior performance. Therefore, the Company reserved the right to modify or improve the Products' specifications or the information in this **Product Brochure and Product Literature** at any time, without notice. The latest Product's specifications and information can be obtained by directly contacting the Company. The Company, as used above, shall refer exclusively to M/s Hightec Chemplast Private Limited as represented by its Board of Directors and any communication directed to the Company may be referred to the contact details of the Company, as provided in this **Product Brochure and Product Literature**.

Important points to be noted:

- § The information given in this Product Brochure and Product Literature is for general guidance only since it is not possible to give specific instructions for various site conditions or to control the plaster applications. Details given in this Product Brochure and Product Literature are approximate and are given to get a broad idea
- § The company reserves the right to modify the information detailed in this Product Brochure and Product Literature, at any point of time, without any notice.
- § It is important that all standard Civil Engineering Practices are followed and adopted for application of Ready-mix plaster.
- § The coverage indicated in this Product Brochure and Product Literature is based on our practical experience and the same can vary from one site condition to another site condition as well as from one applicator to another applicator.
- § In case of further clarification about this product, kindly contact the company's technical persons immediately, before use.

Factory Address :

Hightec Chemplast Pvt. Ltd.

An ISO 9001-2015 Certified Company

Survey No - 1765, Endhal Village, Opp. Samrat Hotel,

NH-48, Navsari, Gujarat. 396 430

Mob : 98216 13159, 76000 68477

E-mail : admin@hitech-india.in | Web : www.hitech-india.in

Corporate Address :

Hightec Chemplast Pvt. Ltd.

An ISO 9001-2015 Certified Company

Office No - 905, Mayuresh Chambers, Plot No. 60,

Sector 11, CBD Belapur, Navi Mumbai 400614

Mob: 98216 13159, 76000 68477

E-mail : admin@hitech-india.in | Web : www.hitech-india.in